

Miniature level transmitters

MTM/N 10



Technical specifications for passive version

Pressure measuring range (mH₂O)

	10 ... 20	> 20 ... 40	> 40 ... 100
Overpressure	3 x FS	3 x FS (≤ 12 bar)	12 bar
Accuracy, (1) (± % FS)	≤ 0.5 / ≤ 0.25	≤ 0.5 / ≤ 0.25	≤ 0.5 / ≤ 0.25
Setting accuracy			
Zero point	± 1mV	± 1mV	± 1mV
Span	± 2 %	± 2 %	± 2 %
Thermal shift, (± % FS/°C)			
Zero point -5...50°C	≤ 0.06	≤ 0.03	≤ 0.015
Span -5...50°C	≤ 0.015	≤ 0.015	≤ 0.015
Long term stability, (2)	≤ 0.2% FS / < 4 mbar	≤ 0.1% FS / < 0.2% FS	≤ 0.1% FS / < 0.2% FS

(1) Best Straight Line (BSL) at ambient temperature

(2) 1 year (typ. / max.)

Typical output signal (mH₂O)

	10 ... 20	> 20 ... 40	> 40 ... 100
Output signal, (1), (mV)	50	100	100

(1) At nominal pressure, 10 V DC

Technical specifications for active version, (1)

Pressure measuring range (mH₂O)

	10 ... 20	> 20 ... 40	> 40 ... 100
Accuracy, (2) (± % FS)	≤ 0.5 / ≤ 0.25 / ≤ 0.1	≤ 0.5 / ≤ 0.25 / ≤ 0.1	≤ 0.5 / ≤ 0.25 / ≤ 0.1
Thermal shift, (± % FS/°C)			
Zero point -5...50°C	≤ 0.06	≤ 0.03	≤ 0.015
Span -5...50°C	≤ 0.015	≤ 0.015	≤ 0.015

(1) For further specifications see ATM/N

(2) Zero based accuracy according to DIN16086, incl. hysteresis and repeatability at ambient temperature

Technical specifications with datalogger, (1)

Pressure measuring range (mH₂O)

	10 ... 20	> 20 ... 40	> 40 ... 100
Accuracy, (2) (± % FS)	≤ 0.1	≤ 0.1	≤ 0.1
Thermal shift, (± % FS/°C)			
Zero point -5...50°C	≤ 0.06	≤ 0.03	≤ 0.015
Span -5...50°C	≤ 0.015	≤ 0.015	≤ 0.015

(1) For further specifications see DL or DL/N70

(2) Zero based accuracy according to DIN16086, incl. hysteresis and repeatability at ambient temperature

Electrical specifications for passive version

Pressure range

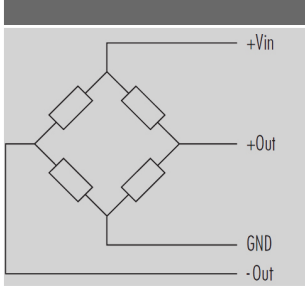
Circuit diagram	
Input impedance	> 10 kOhm
Bridge resistance, (typ.)	3 kOhm
Supply voltage, (typ. / max.)	10 / 15 V DC
Cable length (max.)	200 m

Physical specifications, (1)

Materials	
Transducer	Stainless steel (316L / 1.4435)
Housing	Stainless steel (316L / 1.4404)
Seals	NBR
Cable	PUR, PE

(1) Only for level transmitter MTM/N10

Equipment

Overview

10.00.0091	Accessories overview
-------------------	----------------------

Additional documents

Operating and safety instructions

	Article number
10.88.0369	DMM030

Ordering information

		X. XXXX.	XXXX.	XX.	XXX
Type	MTM/N 10	15			
Pressure type	Gauge	1			
	Absolute (vacuum)	2			
Pressure measuring range	Any pressure measuring ranges between 0...10 mH2O and 0...100 mH2O available, (1)	XX			
Process connection	Closed, (Fig. 1)	55			
	Open, (Fig. 2)	56			
Electrical connection	PE cable, IP 68, (2), (3)		0		
	PUR cable, IP 68, (2)		1		
	PE cable, IP 68, (2), (3), (4)		X		
	PUR cable, IP 68, (2), (4)		X		
	Connectable version, IP 68, (Fig. 5), (5), (6)		3		
Output signal	0...mV (specified by the customer), (Fig. 1 / 2), (8)		13		
	4...20 mA, (Fig. 3), (9)		05		
	0...20 mA, (Fig. 3), (9)		00		
	0...5 V DC, (Fig. 3), (9)		46		
	0...10 V DC, (Fig. 3), (9)		47		
	RS485, (Fig. 5), (6), (9)		62		
Accuracy	$\leq \pm 0.5$ % FS, (7), (8)			0	
	$\leq \pm 0.5$ % FS, (9)			0	
	$\leq \pm 0.25$ % FS, (7), (8)			1	
	$\leq \pm 0.25$ % FS, (9)			1	
	$\leq \pm 0.1$ % FS, (on request), (9)			2	
Temperature range	-5...50 °C compensated (allowed process temperature: -5...50 °C)				4
Option 1					
Option 2					
Option 3					

(1) mH2O, mWS, mWC etc. available

(2) Please specify the required cable length and medium

(3) Suitable for drinking water (food approved)

(4) Connecting cable between MTM/N10 and electronics

(5) Connector with required cable has to be ordered separately (KART100)

(6) Only with datalogger DL/N70

(7) BSL: Best Straight Line

(8) Passive version

(9) Active version

Technical drawings

Dimensions

Fig. 1: Passive version, closed

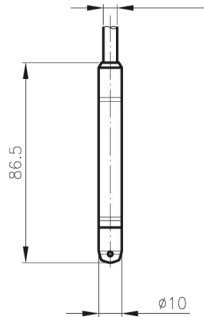

Fig. 3: Active version

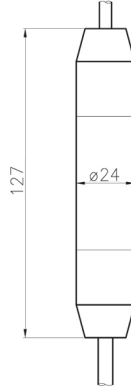

Fig. 5: Version with datalogger
DL/N Series 70

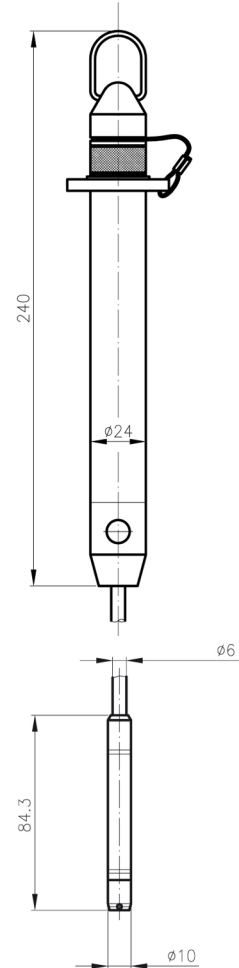
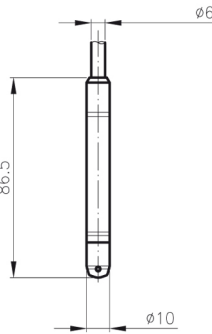
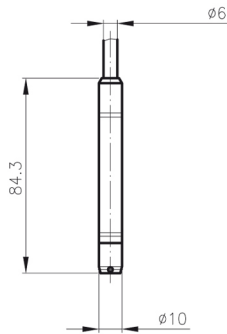

Fig. 2: Passive version, open



Colour	Connection configuration
	Passive version
white	+Vin
yellow	GND
brown	+Out
green	- Out

Connection configuration with separate electronics, see datasheet ATM/N, Series 24

Connection configuration with datalogger, see datasheet DL/N, Series 64/70

Specifications may change without notice.

STG Great Britain:

STG Great Britain Ltd.
Box 3942 | Warwick | CV34 9AE, United Kingdom
contact@stssensors.com | www.stssensors.co.uk

STG Headquarters, Switzerland:

STG Sensor Technik Sirmach AG
Rüthofstrasse 8, 8370 Sirmach, Switzerland
sales@stssensors.com | www.stssensors.com

STG France:

STG France
844 Route de la Caille, 74350 Allonzier la Caille, France
info-fr@stssensors.com | www.stssensors.fr

STG Germany:

STG Sensoren Transmitter Systeme GmbH
Poststrasse 7, 71063 Sindelfingen, Germany
info-de@stssensors.com | www.stssensors.de

STG Italy:

STG Italia s.r.l.
Via Gesù 5, 20090 Opera (Milano), Italy
info-italia@stssensors.com | www.stssensors.it