

DQG-Series Inclinometer

Dual axis inclinometer
Measurement range $\pm 25^\circ$
Voltage output signal



The **DQG-Series** is a small inclinometer based on dual axis tilt sensor for horizontal mounting, which works based on the conductivity principle. This microprocessor controls the inclinometer with a linearized and temperature compensated angle output signal. The unit has metal housing and exhibits an 8...30VDC power supply.

FEATURES

- Robust IP 66 housing
- Cable integrated
- Voltage output signal
- Temperature compensated
- Small size
- Fast response time
- Easy to handle

APPLICATIONS

- Alignment and level control
- Mobile and stationary cranes
- Man lift
- Forklift truck
- Harvester
- Vehicle applications

dimensions [mm]

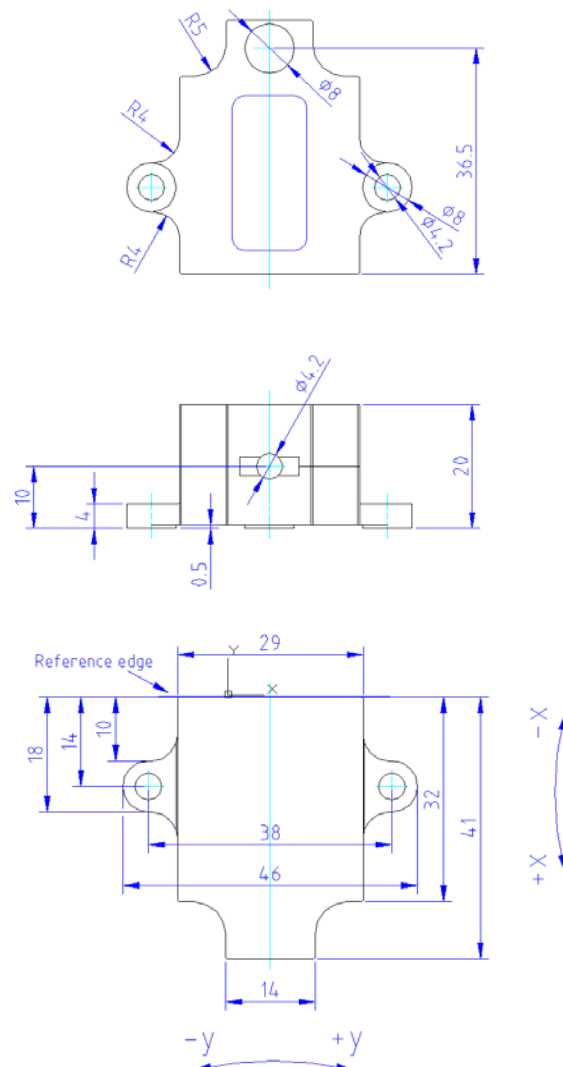

DQG-Series Inclinator

performance specifications

PARAMETERS

| | Conditions | Min | Type | Max | Unit |
|-------------------------------------|---------------------|-----|--------------|-----|------|
| Measurement range | | -25 | | +25 | ° |
| Sensitivity | | | 80 | | mV/° |
| Offset | | | 2.5 | | V |
| Initial Offset | Ta = 25°C | | ±0.2 | | ° |
| Offset temperature drift error | Ta = 0°C...+50°C | | ±0.1 | | ° |
| | Ta = -40°C... +85°C | | ±0.5 | | ° |
| | Ta = 0°C...+50°C | | ±0.5 | | % |
| Sensitivity temperature drift error | Ta = -40°C... +85°C | | ±1.0 | | % |
| | | | 0.1 | | ° |
| Resolution | | | 0.1 | | ° |
| Output signal | to GND | 0.3 | | 4.7 | VDC |
| Power supply | | 8 | | 30 | VDC |
| Current consumption | | | 10 | | mA |
| Operation temperature range | | -40 | | +85 | °C |
| Storage temperature range | | -40 | | +85 | °C |
| Weight | | | 40 | | g |
| Cable, pigtail | | | 500 | | mm |
| Dimensions | W x D x H | | 41 x 46 x 20 | | mm |

Terminal Connections

| Pin | Name | Description | Type | Color |
|-----|------|-----------------------------------|--------|--------|
| 1 | YOut | Y-axis output signal | output | Green |
| 2 | XOut | X-axis output signal | output | Brown |
| 3 | GND | negative power supply, ground | supply | Yellow |
| 4 | Vcc | positive power supply +8...+30VDC | supply | White |

The information in this sheet has been carefully reviewed and is believed to be accurate; however, no responsibility is assumed for inaccuracies. Furthermore, this information does not convey to the purchaser of such devices any license under the patent rights to the manufacturer. Measurement Specialties, Inc. reserves the right to make changes without further notice to any product herein. Measurement Specialties, Inc. makes no warranty, representation or guarantee regarding the suitability of its product for any particular purpose, nor does Measurement Specialties, Inc. assume any liability arising out of the application or use of any product or circuit and specifically disclaims any and all liability, including without limitation consequential or incidental damages. Typical parameters can and do vary in different applications. All operating parameters must be validated for each customer application by customer's technical experts. Measurement Specialties, Inc. does not convey any license under its patent rights nor the rights of others.

ordering info

| PART NUMBER | UNIT | SHORT DESCRIPTION |
|-----------------|----------------|--|
| G - NSDQL - 004 | NS-25/DQG2-XUA | Range +/-25°, Vcc +8...+30VDC, output +0.3...+4.7VDC |